

# "CAMLOCK" COLD STORE PANELS

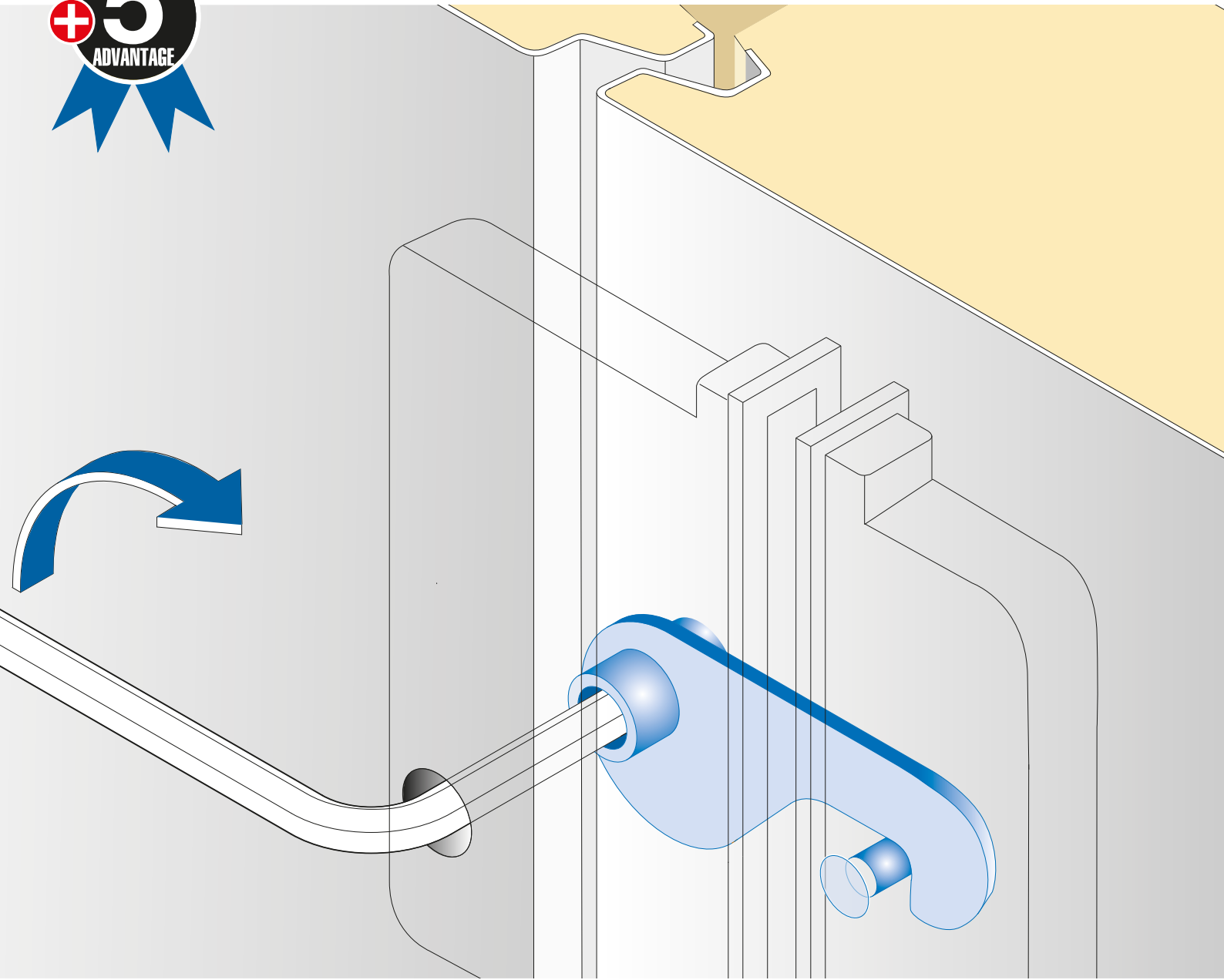

With Continuous Line **Fast Delivery** | With Continuous Line **Full Insulation** | With Special Lock System **Real Disassemble** | Very High **Fire Resistance** | International **Quality & Experience**



**FIREsafe™**





**Kingspan - Izopoli** added a new product to its line of quality and innovative products: **“Lock-Panel”**. Listening and valuing the customers’ needs above all, **Kingspan - Izopoli** has “locked on quality “! Camlock panels, preferred by SMEs, hotels, restaurants, markets and food industry entrepreneurs for their cold room requirements, are now available with **Kingspan - Izopoli** quality and guarantee.

**“Lock-Panel”** camlock cold store panels are, for the first time in the World and only by **Kingspan - Izopoli**, now produced on a continuous panel production line. This means faster delivery, flawless insulation and fire resistance for you.

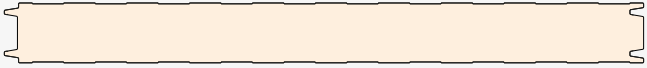
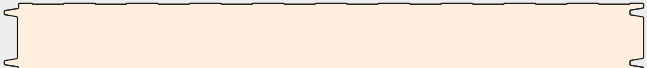

## Technical Data

Thickness mm	Cross-section	K-Value W/m <sup>2</sup> K	Weight	Ceiling Panels maximum span without support (single span)	Wall panels maximum span without support (single span)	
					to 8 m	to 8-20 m
			0.5+0.5	Appx. m	Appx. m	Appx. m
80		0.30	11.62	6.00	5.00	4.00
100		0.24	12.42	7.00	5.50	5.00
150		0.16	14.42	9.00	7.00	6.00

## Stable Dimensions and Durable Thermal Performance

Insulation Material: Rigid polyurethane (PUR) or isophenic (IPN) foam,  
CFC-HCFC free pentane gas

Density : 40±2 kg/m<sup>3</sup>

Fire Resistance : EN13501-1 Euroclass B class

Panel Length : Up to 15 meters according to panel thickness.

Quality Norm : EN14509

Sound Insulation : Approx.25dB in all thicknesses

# “CAMLOCK” COLD STORE PANELS



With Continuous Line  
**Fast Delivery**

With Continuous Line  
**Full Insulation**

With Special Lock System  
**Real Disassemble**

Very High  
**Fire Resistance**

International  
**Quality & Experience**

Production runs on a fully-automatic continuous line, using environment-friendly pentane gas. Insulation foam is laid by the computer on the metal sheets in equal quantity in each squaremillimeter. Result is highly durable panels with completely full and homogeneous insulations.

Cut-to-length **Lock-Panels** can also be produced “FireSafe”. Specially designed eccentric lock mechanism ensures airtight joints and -if required-easy disassembly **Lock-Panels**, are “real” camlock panels offering you real disassembly capability.

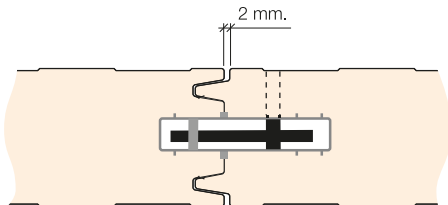
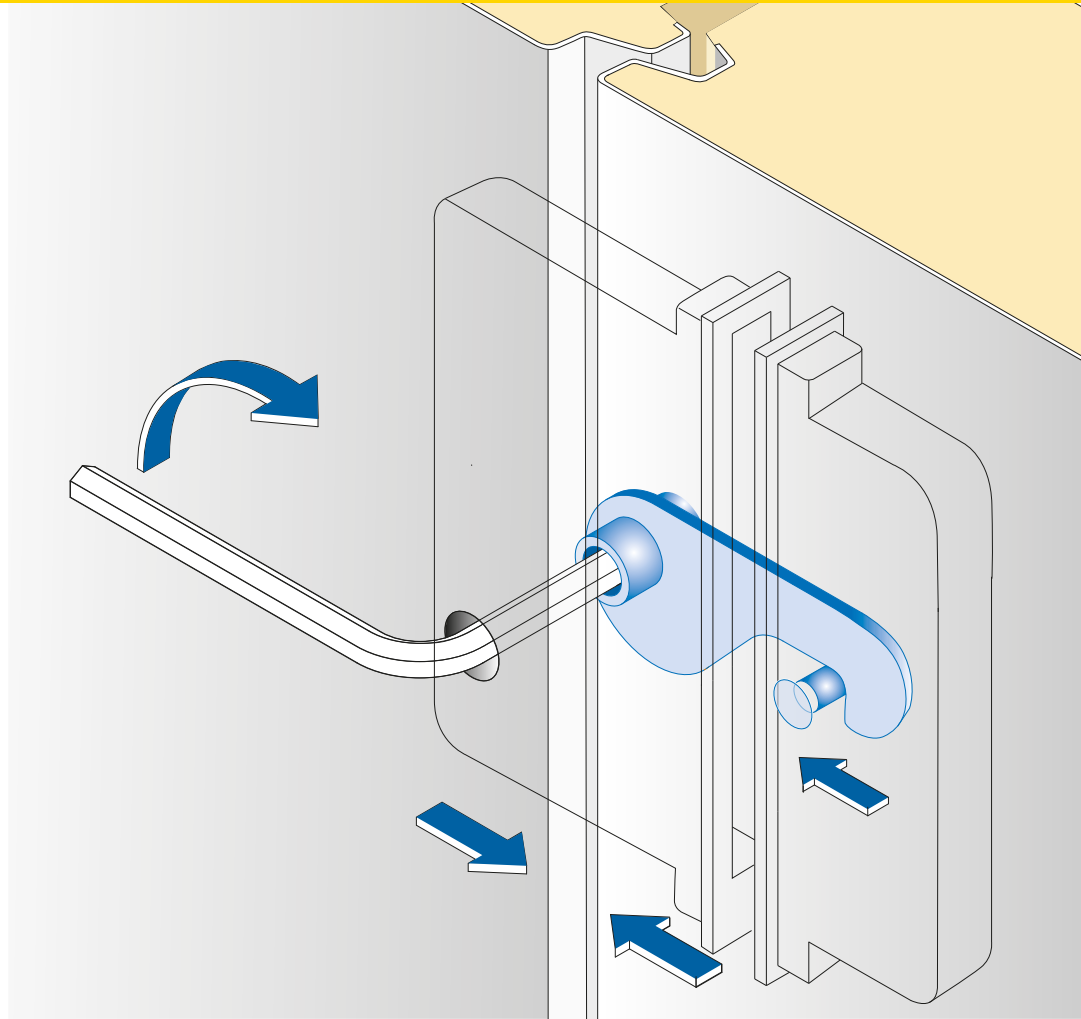

## Joint Detail

With special tongue-groove joint geometry, perfect insulation without heat bridges.

## Avantadges of Continuous Line



### FAST DELIVERY

Our continuous line with its enormous capacity (4000/sqm/day) is the fastest system that will allow meeting any requirement without delay.



### FULL INSULATION

With continuous line laydown system, every bit of volume inside the panel has the same density of insulation foam, i.e. you get totally homogeneous foam structure.



### REAL DISASSEMBLY

Specially designed lock mechanism eliminates welding problems due to corrosion. Lock-Panels can be disassembled anytime you want.



### FIRE RESISTANCE

Conventional camlock panels could not be made of fire-resisting material. Lock-Panel also gives you the possibility of being FM approved FireSafe technology with advanced fire resistance.



### INTERNATIONAL POWER

Lock-Panel is brought to you by the Irish-Turkish partnership of Kingspan izopoli. Kingspan being the global leader in insulated panels market and izopoli being a prominent player in Turkey and surrounding countries have joined efforts to provide you always with quality and innovative products.

Authorized Dealer

**İzopoli** Yapı Elemanları  
Taahhüt Sanayi ve Ticaret A.Ş.

Head Office  
Çırağan Caddesi, No: 97,  
34347 Ortaköy/İstanbul-Turkey  
**T** +90 212 236 60 32 (pbx)  
**F** +90 212 261 39 21

[www.izopoli.com](http://www.izopoli.com) / [info@izopoli.com](mailto:info@izopoli.com)



**FIREsafe™**

Kingspan- Izopoli FireSafe system  
offers the best solution in  
ensuring fire safety.